

# MC RW

## ROOF WINDOW

**aliplast**  
aluminium systems



**curtain wall system**

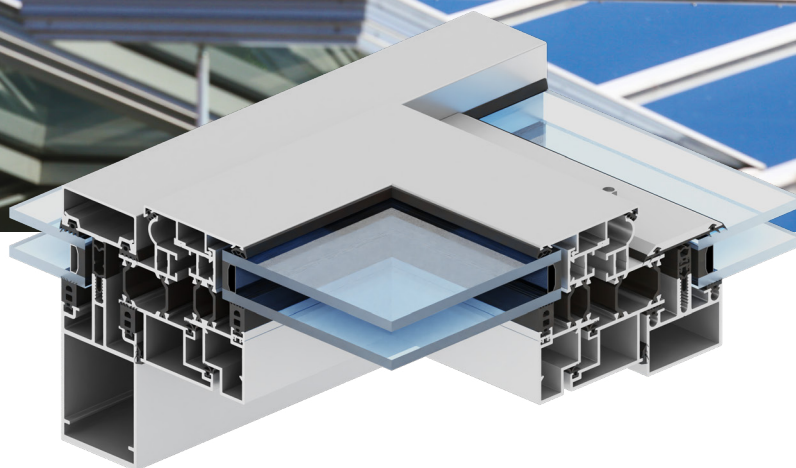

### MC RW roof window

- the MC RW roof window is a solution based on the MC Wall facade system; this type of structures is used to design ventilation flaps
- the window weight is limited by technical parameters of the applied opening mechanisms and hinges; the weight can be up to 150 kg
- the MC RW is a three chamber system with thermal insulation; it is optional to use an additional insulating components to improve thermal aspects of the structure (under-glass inserts, inserts between thermal separators)
- the structure can be installed on roofs with the pitch ranging from 5° to 75° relative to the horizontal
- the MC RW roof window is fitted with an effective drainage and ventilation system integrated with the mullion-transom wall system
- maximum structure dimensions:
  - 2120 x 1120 mm - maximum total pane area: 1,9 m<sup>2</sup>  
(for this overall dimensions it is possible to use 6 ESG/16/442 glass)
  - 1970 x 2070 mm – maximum total pane area: 3,48 m<sup>2</sup>
- the MC RW structure can be used with a wider range of closers available on the market; the MC RW roof window can be fitted with a manual or electrical opening mechanism
- a wide range of colours – RAL palette (Qualicoat 1518), texture colours, Aliplast Wood Colour Effect (wood-like colours), Aliplast Loft View – colours imitating stone surfaces (Qualideco PL-0001), anodised colour (Qualanod 1808), bi-colour

# MC RW

## ROOF WINDOW

**aliplast**  
aluminium systems

curtain wall system

### technical specification

| system | material             | depth of frame | depth of leaf | glazing range | type of windows | type of glazing |
|--------|----------------------|----------------|---------------|---------------|-----------------|-----------------|
| MC RW  | aluminium / polyamid | 87 mm          | 81 mm         | 28-56 mm      | roof window     | glazing strip   |

### performance

| system | thermal insulation Uf* | air permeability  | windload resistance        | watertightness        |
|--------|------------------------|-------------------|----------------------------|-----------------------|
| MC RW  | Uf from 1,70 W/m²K     | Class 4; EN 12207 | Class CE/BE 2400; EN 12210 | Class E2100; EN 12208 |

\* Thermal insulation is dependent on a combination of profiles and thickness of the filling

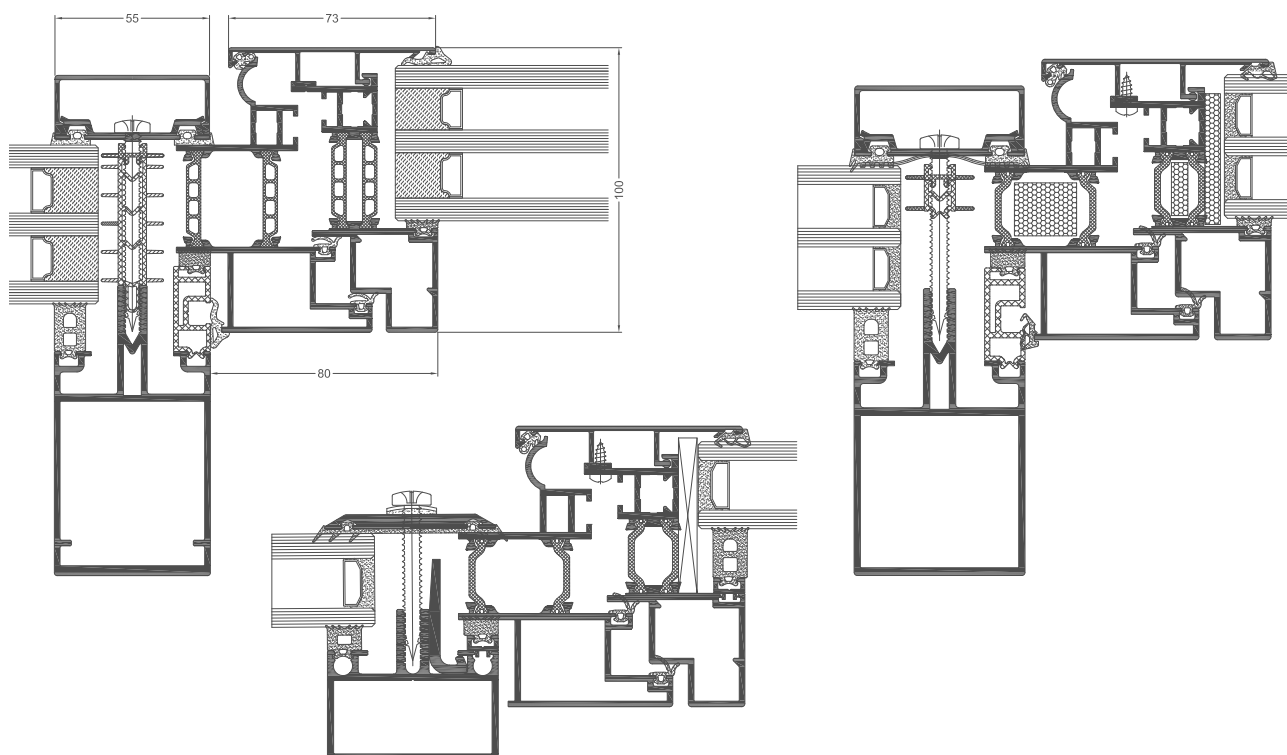

MC RW cross section, sash and transom connections (MC413 + MC311 + MC321)

MC RW cross section, sash and transom connections (MC530 + MC310 + MC320)

MC RW cross section, sash and transom connections (MC011 + MC310 + MC320)